

Hire of Eagle Cottage includes this
Self drive 7 seater (or 525 kg max
weight) diesel dayboat. Fuel to pay for,
with buoyancy aids provided,
for daytime cruising only.

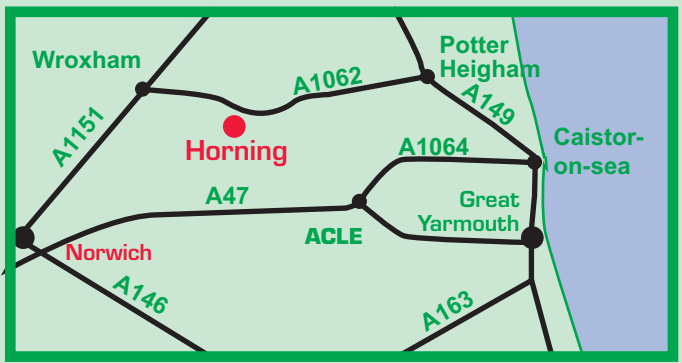

Available only mid-March
to mid-November.
Fully insured.
Minimum age of pilot: 18 years.





Take the A1151 from Norwich to Wroxham then the A1062 to Horning [or from Great Yarmouth take the A149 to Potter Heigham then the A1062 to Horning], turn right into Horning and proceed through the village passing the Swan Inn and The New Inn. Continue to the telephone box and turn right into Ferry Rd., Kingline can be found on the right after approx. 200m.

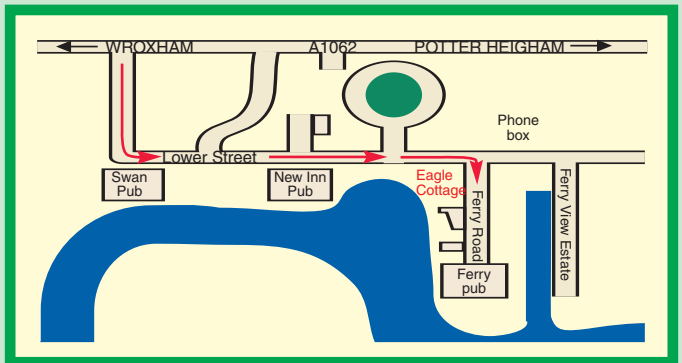

King Line Cottages
Ferry Road, Horning
Norwich. NR12 8PS

Phone: 01692-630297

e-mail: kingline@norfolk-broads.co.uk
www.norfolk-broads.co.uk

Luxury Riverside Cottage

Eagle Cottage

www.norfolk-broads.co.uk
Phone: 01692 630297

WHEELCHAIR ACCESSIBLE COTTAGE
SLEEPS 9



ON THE NORFOLK BROADS



Norfolk

Time to explore



Contact Booking Address:
Kingline Cottages, Ferry Road, Horning,
Norwich. NR12 8PS.
Tel: 01692 630297
Email: info@norfolk-broads.co.uk
Website: www.norfolk-broads.co.uk

Eagle Cottage

- *Sleeps 9*
- *Five bedrooms*
- *Family run for over 11 years*
- *Main river location - children beware!*
- *Ample free parking*
- *No Pets allowed*
- *Comfortable accommodation*
- *Staff "Welcome All" & "Welcome Host" trained*
- *Tourist Board Accommodation Rating 4 star*
- *Wheelchair Friendly*
(Tourist Board Mobility Rating Two)
- *Fishing from lawn in season*
- *Bird Watching*
- *Includes Electric & Heating*
- *Electric Safe*
- *Ground floor annexe*
- *Furnished to a high standard*
- *Large private balcony above lounge for sun-bathing etc*
- *Free cot & high chair (must be pre-booked)*
- *Free loan of adult's wheelchair & shower chair (must be pre-booked)*
- *Bed linen & towels included*
- *Colour TV with free view & video/DVD player*
- *Dish washer*
- *Washing machine*
- *Tumble dryer*
- *Fridge and freezer*
- *Microwave*
- *Full-size cooker*
- *Iron & ironing board*
- *Floor level wheel in shower with hand rails (annexe)*





Enjoying a delightful river frontage location on the banks of the River Bure in the pretty village of Horning. Ideal for watching wild-life and the world go by on small boats, sailing boats and even bus-boats!

A motor-launch is provided for picnics down river or shopping trips to bustling Wroxham which boasts the 'largest village store in the world'.

- Leisure Centre with indoor swimming-pool 100 yards away.
- Horning has shops, 3 Inns (1 of these 3 mins. away), a restaurant and a post-office.
- Riding and Golf within 15 miles
- Cycling paths eg Weavers Way, Bure Valley
- Nature trails for bird-watching enthusiasts close by and along the coast.
- NT Houses eg Blickling and Felbrigg within easy reach for day trips.
- North Norfolk Steam Railway 35 mins. by car
- Medieval city of Norwich 12 miles away, has a Cathedral, a 12th century Norman Castle which houses a Museum, a Theatre, good shopping, & a lively market
- Great Yarmouth 17 miles away, has a racecourse and provides all-weather family entertainment.
- Family entertainment also at Dinosaur Adventure Park, Pettitts Animal Park, Wroxham Barns.
- Sandy Beaches along the north-east coast of Norfolk.

Ground Floor

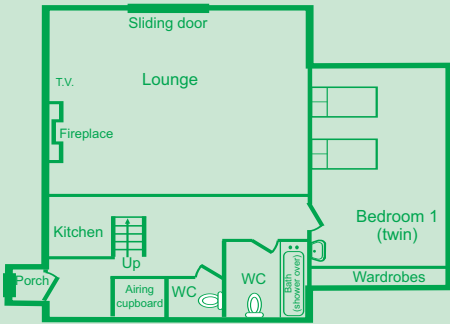

First Floor

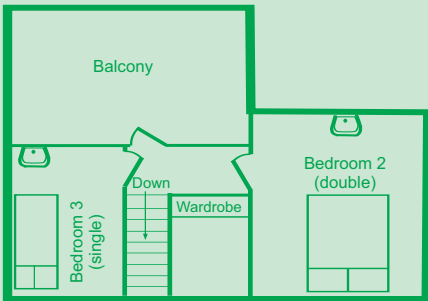

Annexe

